

AIBOCN
The wisdom of Life

USER MANUAL

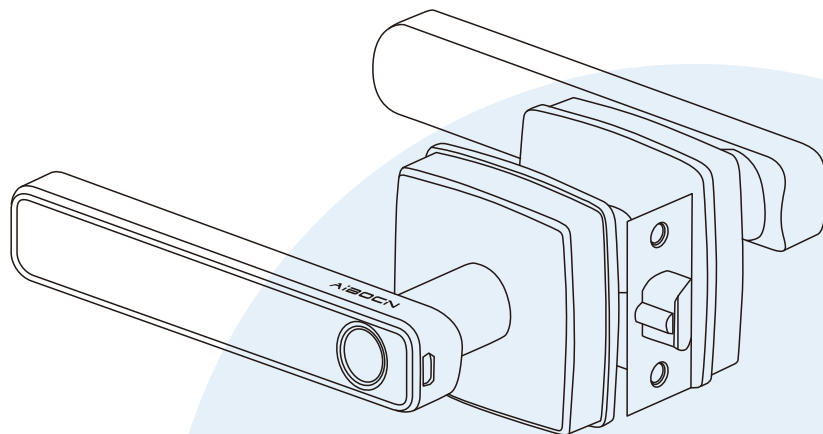

Smart Lock Installation guide

MODEL: N1TY

WELCOME TO AIBOCN SMART LOCK

TABLE OF CONTENTS

Contact Aibocn Customer Support	01
Packing List	02
Product Overview	03
Product Profile	04
Features	04
Installation	05
1. Preparing Door	05
2. Adjust Latch Backset Length	06
3. Install Latch and Strike & Strike Box	06
4. Install Exterior Assembly	07
5. Install Interior Assembly	07
FAQ	09

Important Notes

1. This lock comes with a mechanical key. Please store it in a safe and easily accessible place.
2. Batteries: It is recommended to use 4 AAA alkaline batteries (not included with the product).
3. The effectiveness of fingerprint recognition may be affected by liquids. Please ensure your hands and the fingerprint reader are dry.
4. Before removing the original door lock, please install and test our door lock to ensure proper functionality, avoiding potential lockouts due to product malfunction after installation.
5. If you need to return the product, please contact customer service for further assistance.

Please read this manual before using the smart lock and keep it properly for further reference.

NEED HELP?

Support Email: service@aibocn.net

Packing List

A

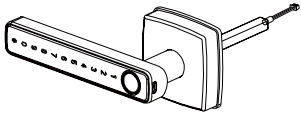

Outdoor lock body * 1

B

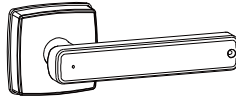

Indoor lock body * 1

C

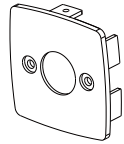

Mounting plate * 1

D

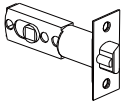

Single latch * 1

E

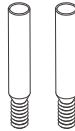

40mm
Cylindrical sleeve bolt * 2

F



M4 x 30mm cross
flat head bolt * 2

G

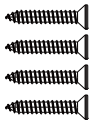

M4 x 25mm
cross flat head
self-tapping
screw * 4

H



M4 cross flat
head bolt
8mm* 1+6mm*2

J



Mechanical
key * 2

K

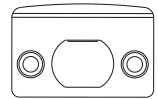

Strike plate * 1

L

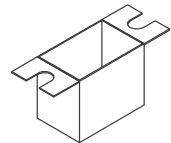

Latch holding
plastic box * 1

Product Overview

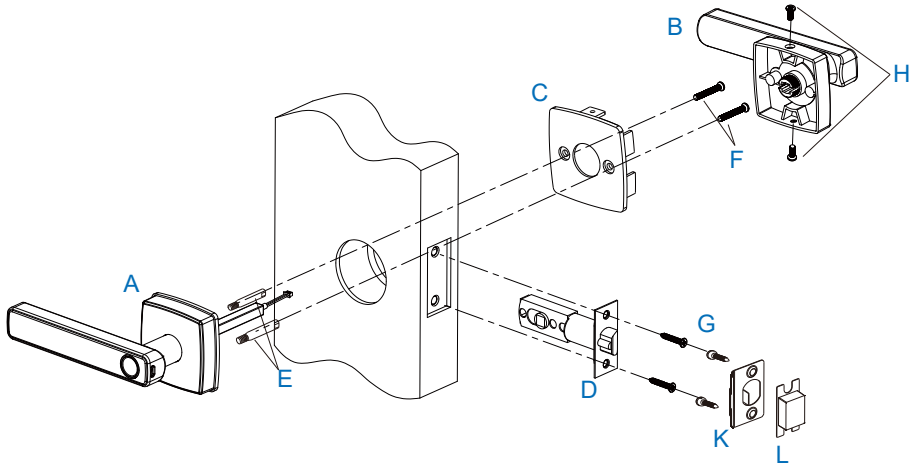

Fingerprint Reader

Verify your fingerprint to unlock.

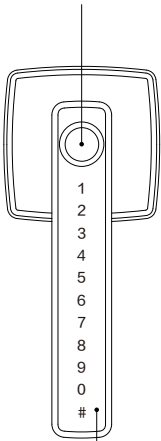

Keypad

Enter code to unlock.

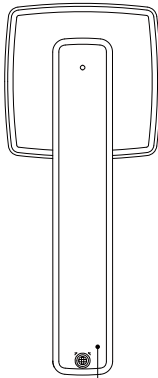

Battery cover

Need 4 ×AAA Alkaline batteries

Type-C USB (5V)

Used to connect power bank to activate the lock when battery runs out.

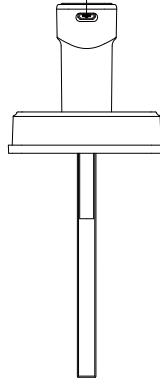

Keyhole

Insert the mechanical key to unlock.

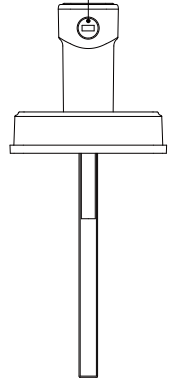

Product Profile

Specifications

Material	Zinc Alloy	Model NO.	N1TY
Door thickness	38mm-50mm	Code Length	6~10 digits
Working Temperature	-20°C~70°C	Working Humidity	20%~80%RH
Working Power Consumption	<200mA	Static Power Consumption	<30uA
Power Supply	6V (4 x AAA Alkaline Batteries)		
Unlocking Methods	App, Fingerprint, Password & Mechanical Key		
User Capacity	Totally 255 fingerprint / password / temporary password users (100 fingerprint users at most)		
Product Dimension	Front / Back panel	65 x 65 mm	
	Handle Length	167 mm	

★ All specifications are subject to change without notice. All rights reserved.

Features

- **Four Ways to Access the Lock:** App Access, Fingerprint, Password & Mechanical Key.
- **Rugged:** Zinc alloy body and strong handle design prevents forcible entry.
- **Idling Lock Handle Design:** When the door is locked, the clutch is in idle position, the front handle will be turned. However, the door will remain locked.
- **Battery Dead Alarm:** If the batteries are running low, the door lock will inform you through sound prompts. You can also check battery level on the mobile App.
- **Emergency Power Supply:** Emergency power supply interface equipped on the side of the front handle: to unlock the lock temporarily by connecting to the emergency power supply interface with a backup battery connect by USB cable.
- **Real Time Record:** You can check unlock records in real time on your App.
- **App Control Door Lock via Bluetooth:** Connect through Tuya APP to get more functions.

Installation

Please scan this QR code to watch the easy step by step installation video before attempting to install your smart lock.



1. Preparing Door

Check the door's dimensions.

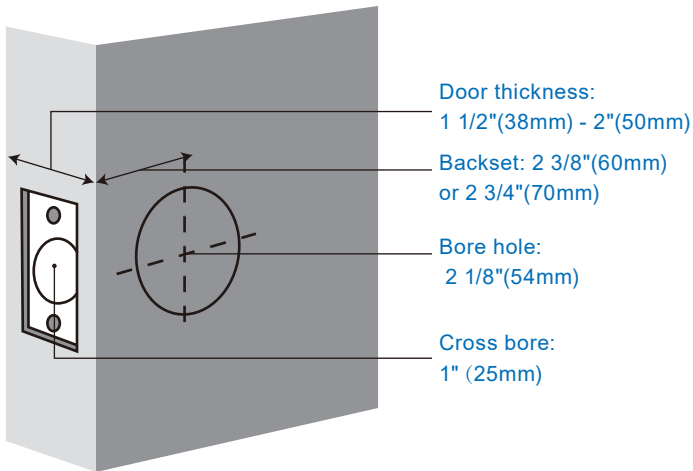

- Make sure the door thickness is between 1.49in-1.97in (38mm-50mm)
- Make sure the backset between the center of the door hole and the edge of the door is 2.36in or 2.75in (60mm or 70mm)
- Make sure the bore hole in the door is 2.12in(54mm)
- Make sure the cross bore in the door edge is 0.98in (25mm)

2. Adjust Latch Backset Length

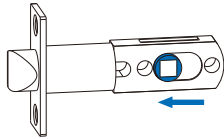

2-3/8" (60mm)

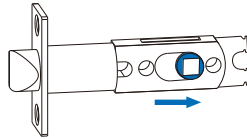

2-3/4" (70mm)

Measure your door backset, then adjust to the corresponding latch length (60mm or 70mm).

3. Install Latch and Strike & Strike Box

Step 1 Check Latch's Status

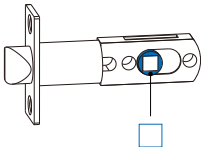

Correct: Horizontal

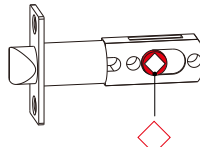

Error: Inclined

Step 2 Install strike (K) & strike box (L) on the door frame with screw (G)

Step 3 Install latch into the door with screw (G)

Tips: For optimal coordination with the locking mechanism, please replace your existing latch with the included one.

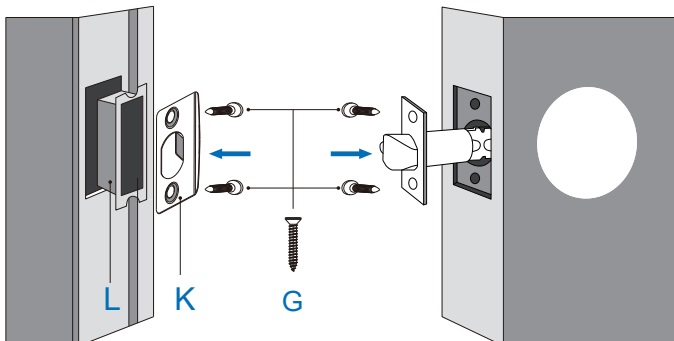

4. Install Exterior Assembly

Step 1 Fixed bolts (E) on exterior handle (A)

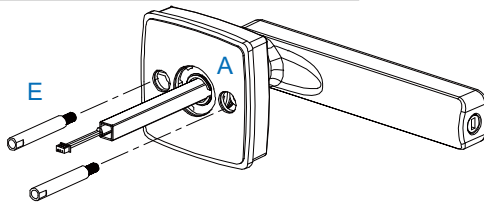

Step 2 Install exterior handle (A)

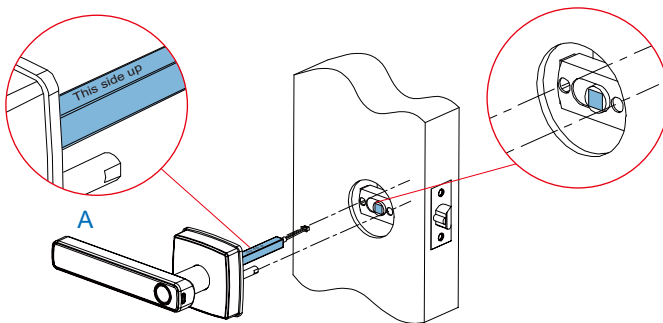

Note: Make sure the long side of the handle with the words "This Side Up" is up and through the vertical square hole in the deadbolt.

5. Install Interior Assembly

Step 1 Install mounting plate (C) on the door

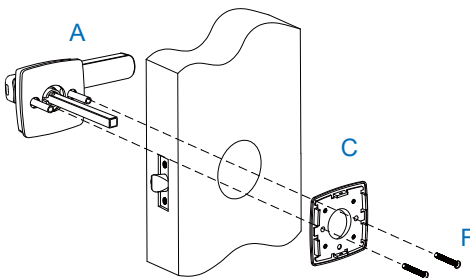

Step 2 Install Interior Handle (B) on the door

1. Pass the wire through the rear handle and install the corresponding color side to the socket according to the label instructions on the rear handle.
2. Install screw H (6mm) to handle B.
3. Install 4 × AAA Alkaline batteries.
4. Press and hold the black button for 6 seconds to reset the lock. (When you hear a beep it indicates a successful reset).

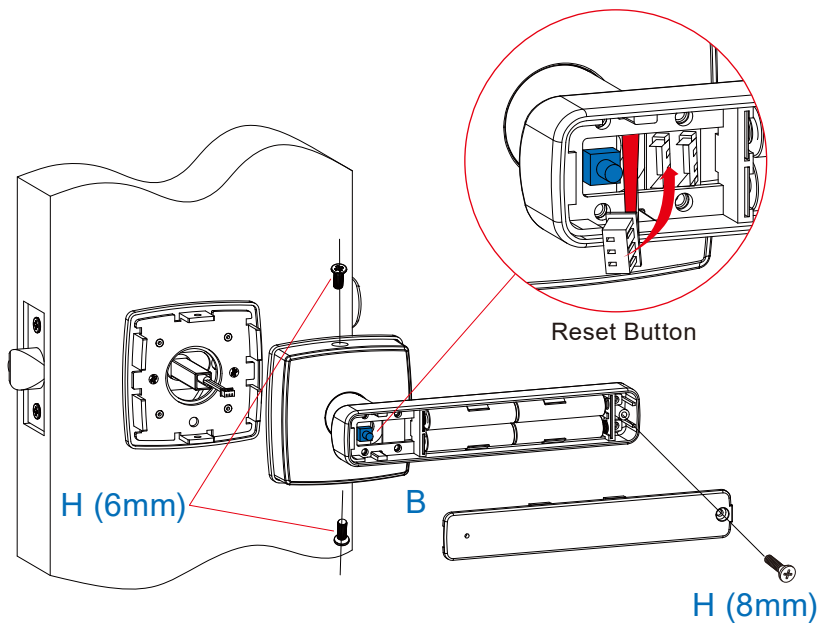

FAQ

Q1: Why can't the door close after installing the biometric door lock?

A1: Because the direction of the latch is wrong, please refer to the user manual to adjust the direction of the latch.

Q2: Do I need to drill holes to install the door handle lock? If needed, what type of drill should I use?

A2: No need.

Q3: What type of door is this automatic door lock suitable for?

A3: Most standard residential wooden doors.

Q4: What range of thickness is this smart lock with handle suitable for?

A4: 1.49 inches -1.97 inches.

Q5: What type of battery do I need to use? How long will the battery last?

A5: We recommend that the Bluetooth door lock uses 4 AAA alkaline batteries, but you can also use rechargeable batteries! About 3-6 months.

Q6: Can I turn off the auto-lock feature?

A6: Yes.

Q7: Can the phone display the remaining battery life of the lock?

A7: Yes.

Q8: Why is fingerprint recognition not sensitive?

A8: The fingerprint recognition effect will be affected by liquid, please keep your fingers and fingerprint reader dry.

Q9: Why doesn't fingerprint recognition work?

A9: Please check if the wires are connected properly.